

**TITLE: Vieo Warm Roof (On Ply, OSB or Timber Deck)**

**DWG NO: V2\_WR\_TD\_System**

**SCALE: NTS**

**ISSUE DATE: Nov 2011**

Drawn by: PCI Checked by: JP

(To be read in conjunction with Vieo system specification documents)

**Euro Clad Ltd,  
Wentloog Corporate Park,  
Wentloog Road, Cardiff CF3 2ER  
Tel: (+44) 029 20 790722,  
Fax: (+44) 029 20 793149  
Website: www.vieorooft.com**

This detail has been supplied by Euro Clad Ltd for the purposes of addressing the objectives of the specification. Euro Clad Ltd does not accept any liability for any errors or omissions or for any consequences arising from the use of this information. The drawing is copyright, it remains our property. We reserve the right to change the details without notice.

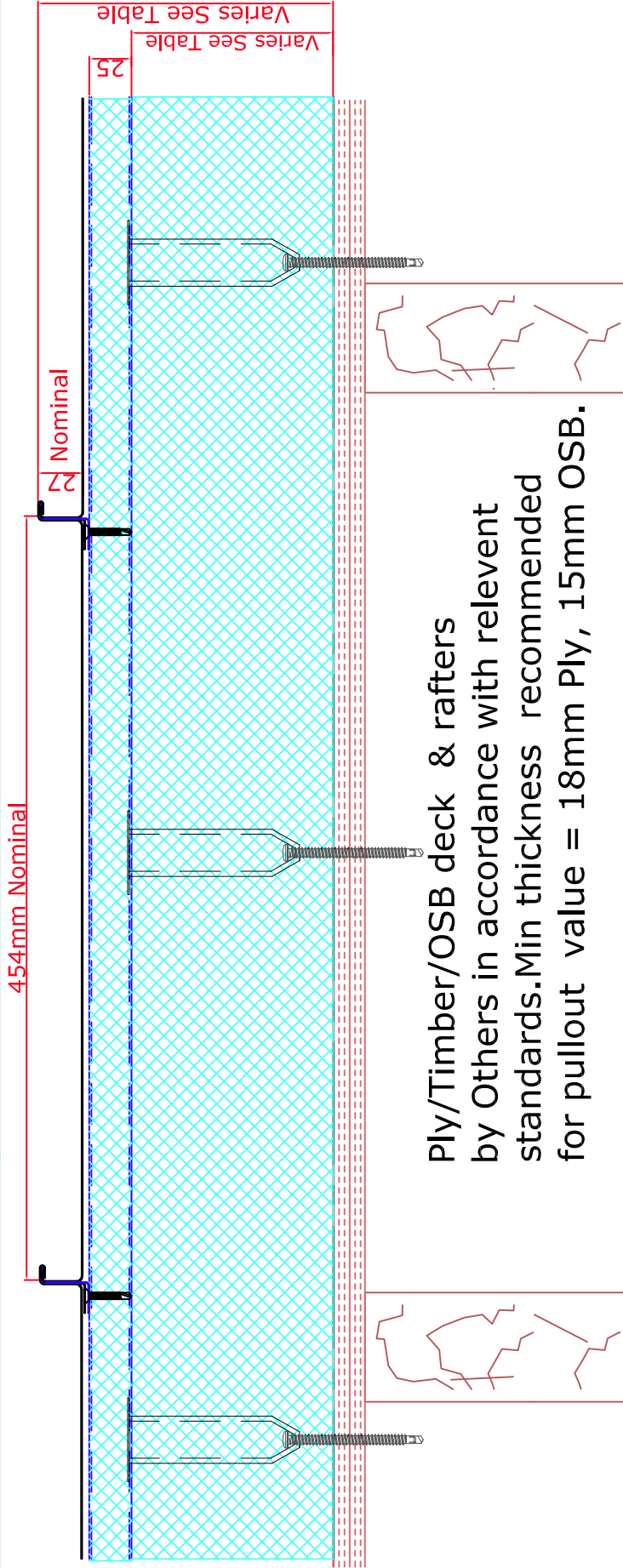

**Ply/Timber/OSB deck & rafters**  
by Others in accordance with relevant standards. Min thickness recommended for pullout value = 18mm Ply, 15mm OSB.

<b>U Value (RocSlab)</b>	<b>0.25</b>	<b>0.20</b>	<b>0.18</b>	<b>0.15</b>
<b>Insulation Depth</b> (Excluding 25mm upper slab)	120mm	155mm	180mm	215mm
<b>Overall System Depth</b> (From Top of Deck)	174mm	209mm	234mm	269mm
<b>U Value (RocSlab Lite)</b>	<b>0.25</b>	<b>0.17</b>	<b>0.15</b>	<b>0.11</b>
<b>Insulation Depth</b> (Excluding 25mm upper slab)	90mm	130mm	150mm	180mm
<b>Overall System Depth</b> (From Top of Deck)	142mm	182mm	202mm	232mm
<b>Overall System Depth</b> (From Top of Deck)	142mm	182mm	202mm	232mm
<b>Overall System Depth</b> (From Top of Deck)	142mm	182mm	202mm	232mm